

FUTURO Wallbox

The FUTURO Wallbox is a smart charging system integrated in a sturdy wooden column in typical Timberlab style. The Wallbox can be used for both type 1 and type 2 cars and is suitable for companies and individuals. A great solution for your holiday home, residence, parking lot or business premises. You can easily keep track of the charging status via the app. Feel free to contact us for more information about the FUTURO Wallbox.



SPECIFICATIONS

- **IP class:** IP54/IK08
- **Temperature:** -25 to 400 C.
- **Voltage:** 230V/7.4kW 32A - 400V/11kW 16A - 400V/22kW 32A
- **Cable:** 5 x 6mm²
- **Socket type:** Type 2
- **Interface:** Wi-Fi/Ethernet/Bluetooth
- **Status information:** RGB LED/Wallbox app & portal
- **Feature included:** Power Sharing Smart
- **Lifespan:** Every type of wood has its own durability rating. More information about this can be found under "Types of wood" & "Sustainability".

OPTIONS

- **Power plug:** Type 1 or 2
- **Extra function:** Residual current detection + RFID
- **Quality mark:** PEFC
- **Variations:** At Timberlab, every fixture is carefully produced for you. In addition to the standard options, we are happy to create variations for your application. Think of a different height angle, for example.

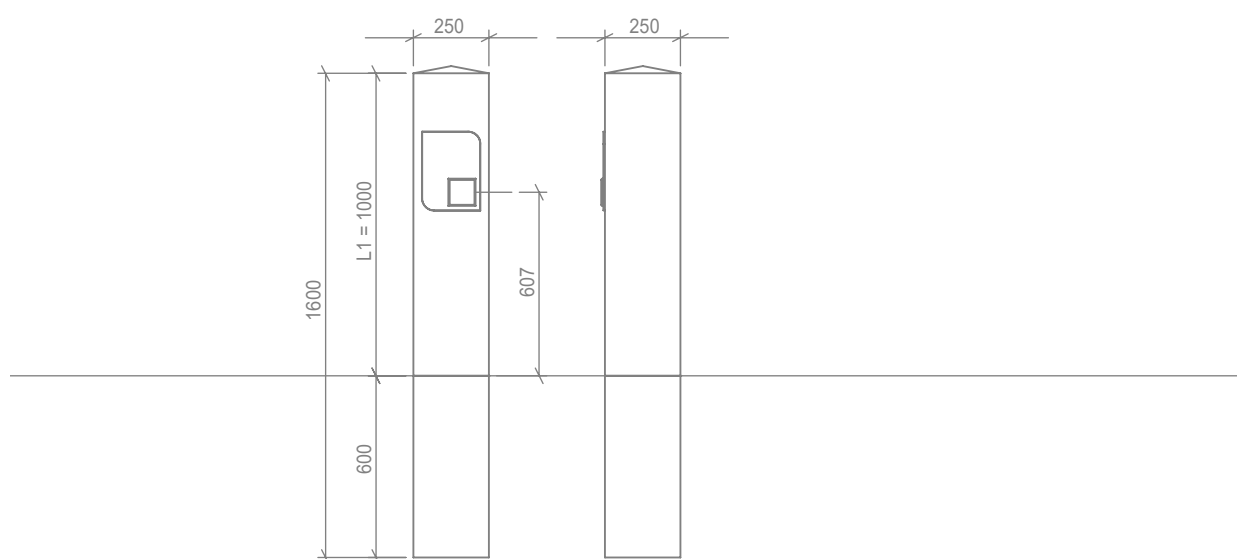

	weight	CO2 storage
Oak	50 kg	77 kg



Only products indicated with the FSC® claim are FSC certified and come with our FSC-certificate number NC-COC-029615-KE. Only products indicated with the PEFC™ claim are 100% PEFC certified and come with our PEFC-certificate number NC-PEFC/COC-029615-FJ.